



adastra[®]

H25 Handheld Wireless PA

(952.410)

User Manual



Features:

- Rechargeable battery operation
- VHF neckband microphone system
- Built-in USB media player
- Integral handle and shoulder strap

Introduction:

Thank you for choosing the Adastra H25 portable PA system. This all-in-one unit is designed to offer convenient and reliable portable amplification for a wide range of small public address applications. Please read this manual before using this equipment in order to avoid damage through incorrect operation and to get the best performance from your purchase.

Contents:

Please take care when unpacking this product. Inspect for any damage and ensure you have the following components...

- H25 Handheld PA speaker unit
- VHF beltpack transmitter
- Neckband microphone
- Shoulder strap

Warning:

To prevent the risk of fire or electric shock, do not expose any of the components to rain or moisture. If liquids are spilled on any component, stop using immediately, allow unit to dry out and have checked by qualified personnel before further use. Avoid impact or heavy vibration to any of the components, dropping the microphone can cause capsule failure. No user serviceable parts inside transmitter or receiver except for battery/charging access - refer servicing to qualified service personnel.

Safety

- Ensure that mains supply voltage is correct for charging via the integral lead
- Avoid ingress of water or particles into the unit or beltpack transmitter
- Use alkaline or NiMH batteries in the transmitter and remove if unused for long periods.
- Observe the correct polarity when replacing batteries
- Do not attempt to charge USB devices from the type 'A' connector

Placement

- Keep all components out of direct sunlight and away from heat sources.
- Avoid impact or crushing of components
- Keep all components away from damp or dusty environments.

Cleaning

- Use a soft cloth with a neutral detergent to clean the outside of each component
- Lightly damp sterile wipes may be used on the microphone head for hygiene purposes
- To avoid damage, do not use solvents to clean the components

Handheld PA Unit

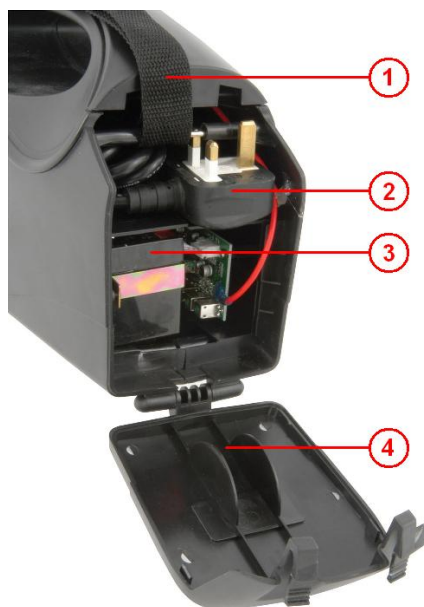

1. Shoulder strap
2. Mains recharging lead
3. Sealed rechargeable battery
4. Rear compartment cover



5. USB player transport controls
6. VHF microphone On/Off/VOLUME control
7. VHF microphone carrier signal indicator
8. VHF microphone TONE control
9. POWER/CHARGING indicator
10. AUDIO OUTPUT 3.5mm jack
11. ON/OFF power button
12. USB connector
13. MIC IN 6.3mm jack

Beltpack Transmitter and Neckband Microphone

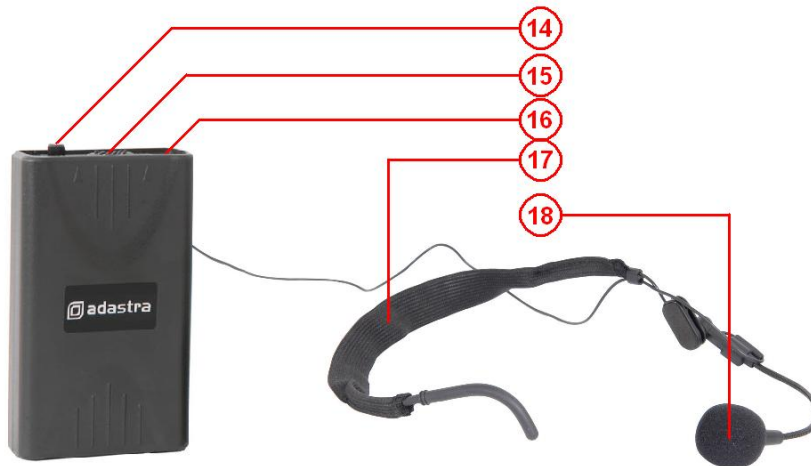

- | |
|---|
| <p>14. Transmitter LEVEL control
15. Slide switch – OFF/MUTE/ON
16. Microphone input 3.5mm jack
17. Neckband
18. Condenser microphone</p> |
|---|

Operation

The H25 portable PA unit is switched on using the ON/OFF rocker switch (11) at the bottom of the control panel

The rear compartment of the H25 houses the mains charging lead (2). When this is connected to the mains (ensuring correct voltage), the H25 operates from mains when switched on and charges the battery when switched off. Full charging from empty takes approximately 4½ hours. An indicator LED (9) shows when power is on or charging the battery (if the H25 is switched off).

Switching on the H25 with no mains plugged in operates from the internal battery and should offer up to 8 hours operation from a full charge, depending upon the usage and output volume.

There is a USB type A socket on the control panel (12). Plugging in a USB pen drive containing compressed digital audio files enables them to be played through the unit. Play/Pause functions and moving through different tracks on the memory device are controlled by 3 transport buttons (5) above the USB connector.

A 3.5mm jack (10) carries audio output at line level which can be connected to further amplifiers or active speakers if required.

For the wireless system, sliding down the back half of the beltpack housing reveals the battery compartment. Place an alkaline or NiMH PP3 battery inside (ensure + and - are the correct way round) and then slide the housing back together.

Plug in the supplied neckband microphone, slide the OFF/MUTE/ON switch (15) to the ON position and turn up the LEVEL rotary control (14) approximately half way. Sliding the OFF/MUTE/ON switch mid-way maintains the VHF carrier signal but mutes the audio from the microphone.

The built-in receiver in the H25 unit is controlled by 2 rotary controls on the control panel. When the OFF/ON/VOLUME control (6) is turned fully off, the VHF receiver is powered down. Turning this control up gradually activates the receiver and increases the level. When the receiver detects the beltpack transmitter (switched on), the RF indicator (7) will illuminate.

Adjust the OFF/ON/VOLUME level to the required output and increase or decrease the output level on the beltpack if necessary. Below the OFF/ON/VOLUME control is a TONE (8) control for the wireless microphone. Turning the tone down can help avoid “squealing” feedback from excessive treble content or turning up will add more treble for clearer speech.

Also, a wired microphone or wireless receiver may be connected to the MIC IN 6.3mm jack socket (13) to be used instead of or in addition to the built-in wireless set.

Care should be taken to avoid “line-of-sight” positioning of the H25 speaker and any microphones being used, which can cause feedback (howling or squealing caused by the microphone ‘hearing’ its own output through the speaker). Furthermore, the H25 should not be positioned too close to the microphone(s) being used for this reason.

After use, turn down the OFF/ON/VOLUME control fully down to power down the VHF receiver, switch off the beltpack transmitter and switch off the power switch on the H25 unit. If mains is connected, stow the lead carefully inside the rear compartment and store the unit upright in a dry place away from excessive heat or sunlight.

SPECIFICATIONS	
Power supply: main unit	Mains or internal rechargeable battery
Power supply: VHF beltpack	9Vdc PP3 battery
Output power: max	25W
Frequency response	100Hz - 12kHz
S/N ratio	>60dB
VHF operating distance	35.0m
VHF tuning stability	0.005% quartz crystal locked
Dimensions: VHF beltpack	205 x 68 x 25mm (ex. antenna)
Weight: VHF beltpack	76g (no battery)
Dimensions: main unit	155 x 183 x 285mm
Weight: main unit	2.74kg

Troubleshooting

"POWER/CHARGING" LED not lit when using mains power	Check for correct voltage and that outlets are switched on
	Check if mains fuse has blown
"POWER/CHARGING" LED not lit when using battery power	Check POWER switch is switched on
	Battery may be fully discharged, connect to mains if available
"POWER/CHARGING" LED is on but "RF" LED is not lit	Ensure transmitter is switched to ON or MUTE with a good battery installed
	Check that beltpack transmitter is not out of reception range
	Check that VHF OFF/ON/LEVEL control is not switched off
"POWER/CHARGING" and "RF" LEDs are lit but no mic output	Check if beltpack transmitter switch is in "MUTE" position
	Check if neckband microphone is properly connected to beltpack
	Ensure transmitter has good / charged batteries
	Check if there is another nearby transmitter with the same frequency
Microphone output is very loud or distorted	Turn down LEVEL control on beltpack transmitter
	Turn down OFF/ON/LEVEL control on the H25 to a reduced level
Microphone output is very low	Turn up LEVEL control on beltpack transmitter
	Turn up OFF/ON/LEVEL control on the H25
	Check transmitter batteries
USB player will not play audio files	Check that file type is standard and 44.1KHz 16-bit format
	Check USB memory device on different equipment to ensure working properly
	Press PLAY button or jump to other tracks to make sure file is not corrupt
	Remove and replace USB device to check if connected properly
USB player output very low	Press and hold the VOL + button to increase volume level
	Check that audio file is not recorded at very low gain level - if so, correct this on a PC/Mac
USB player output very high or distorted	Press and hold the VOL – button to decrease volume level
	Check that audio file is not recorded at very low gain level - if so, correct this on a PC/Mac

Note: for further troubleshooting, refer equipment to qualified service personnel for testing